



# User manual

Nov 2022

Thank you for trusting bike 43 to transport your children, commissions and items. We wish you many years of pleasure riding your bike 43.

We are open to your comments and will carefully evaluate your comments and suggestions in order to continue improving the product. You can contact us on our website if you wish to share some feedback.

#### **SAFETY RECOMMENDATIONS**

ALWAYS WEAR SUITABLE CLOTHING, AND MAKE YOURSELF VISIBLE TO MOTORISTS.  
WEARING A HELMET IS RECOMMENDED FOR YOU AND YOUR PASSENGERS.

IN THE EVENT OF A FALL, MAKE A FULL REVIEW OF YOUR BIKE.

IF YOU DETECT A PROBLEM, DO NOT OPERATE YOUR BIKE UNTIL YOU HAVE SETTLED THE PROBLEM.

CHECK YOUR BIKE BEFORE EACH USE.

READ THIS MANUAL CAREFULLY BEFORE YOU FIRST USE YOUR BIKE.

FOR THE ADJUSTMENT AND MAINTENANCE OF CERTAIN COMPONENTS, PLEASE REFER TO THE INSTRUCTIONS ATTACHED WITH YOUR BIKE OR ASK YOUR DEALER FOR ADVICE.

## Table of Contents

1.	Type of use.....	4
2.	Before you start .....	5
3.	Getting started and adjustments .....	6
3.1.	Height of the saddle .....	6
3.2.	Seat tilt .....	7
3.3.	Handlebar adjustment .....	7
4.	Settings .....	8
4.1.	Enviole continuously variable gearing .....	8
4.1.a	Checking the cable tension .....	8
4.1.b	Removing the rear wheel.....	10
4.1.c	Refitting the rear wheel.....	11
4.1.d	Cleaning .....	11
4.1.e	Lubrication .....	11
4.1.f	Operation of the shifter.....	12
4.2.	Brakes.....	12
4.3.	The wheels .....	13
4.3.a	The tyres .....	13
4.4.	The stand.....	13
5.	Miscellaneous recommendations.....	13
5.1.	Tightening torques .....	13
6.	Maintenance.....	14
6.1.	Battery.....	14
6.2.	Maintenance schedule .....	15
6.2.a	Before & after each trip.....	15
6.2.b	Every months .....	15
6.2.c	Every six months (depending on the frequency, and the type of use) .....	15
6.2.d	Every two years.....	15
6.2.e	Safety warning .....	15
7.	Cleaning and lubrication .....	16
8.	Parts subject to wear .....	16
9.	Basic information on the pedal assistance system .....	17
9.1.	Getting started .....	17
9.2.	Lithium-ion battery .....	17
10.	Guarantees and after-sales .....	18
10.1.	Warranty only applies .....	18
10.2.	The warranty does not apply .....	19

## 1. Type of use



First of all, it is important to check that the bike you have just purchased corresponds to the use you want to make of it.

Failure to comply with the conditions of use described below may result in risks for the user and a restriction of the warranty conditions.

The bike 43 bike is designed for use in an urban environment, on paved, paved roads, cycle paths. It can occasionally be used on gravel or unpaved roads in good condition.

The geometry of the frame has been studied for users from 1.50 m to 1.90 m approximately. However, you should always check with your authorized retailer that it is suitable for your body type.

It is designed for users up to 100 kg and the luggage rack can support a load of 100 kg. The combined weight of the user, passengers and baggage cannot exceed 170kg.

Bike 43 has large tyres for more comfort, but it was not designed for jumps, all-terrain, rough or competition use.

It complies with standard EN14764 'Bicycles used on public roads' and with EN15194 'Cycles with electric assistance'.

## 2. Before you start

- Your bike has been prepared, checked and adjusted for your safety and enjoyment by our authorized dealer.
- Before your first ride, we invite you to read and follow the instructions below. They will allow you to ride safely and make the most of your Bike 43:
- Always wear an approved helmet and appropriate equipment for you and your passengers.
- Always carry out a complete check of your bike before riding (tightening of the handlebars, stem, saddle, wheels, brakes).
- In all circumstances, respect the highway code of the country in which you operate so as not to endanger yourself. Some countries impose specific equipment or safety rules. Make sure you respect the laws in force locally.
- On the road, make yourself visible to motorists when weather conditions dictate. Use equipment with high reflective and luminous power to signal your presence.
- An electric bike allows you to ride regularly at 25 km / h even on uphill. Attention, from experience, other users, motorists, cyclists, pedestrians are often not used to these travel speeds for a bicycle. You should therefore anticipate their reactions as much as possible and slow down if necessary.
- Take the time to get used to your new bike. Powerful disc brakes don't require you to pull the lever hard to slow down, get used to their behaviour. Also be sure to measure it on both dry and wet surfaces, with and without loading. In fact, you will find that the braking power available at the rear is high and could surprise you unladen in conditions of poor grip.
- An electric bike has a slightly different behaviour from a normal bike, in particular, it accelerates faster. Progressive practice and appropriate training will help develop your skills.

Also be aware that after a short break-in period, the cable tensions, brakes and steering may require adjustment. It is advisable to go to your authorized dealer for this operation. If anything seems abnormal during this period, or if you have any questions about the use of your bicycle, do not hesitate to contact your dealer.

In addition, for your safety and to guarantee optimal and lasting operation of your Bike 43, you can establish with your retailer a periodic maintenance schedule. The latter will be determined according to your outing frequencies, the mileage performed, your style of practice, as well as the terrain encountered.

Your Bike 43 dealer is the best person to advise you and carry out all maintenance operations, but if you prefer to do some of them yourself, you will find some advice on the following pages.

### 3. Getting started and adjustments

It is essential to adapt your bike 43 to your body type for optimal comfort.

#### 3.1. Height of the saddle

The first point is the height and the inclination of the saddle. Again, your retailer can help you with this. Do not hesitate to adjust it if you do not find your position immediately.

There is a trick to quickly obtain an adequate adjustment for your optimal performance: position the crank in the extension of the seat tube, without being swayed on the saddle and placing the heel on the pedal, the leg should be barely tense.

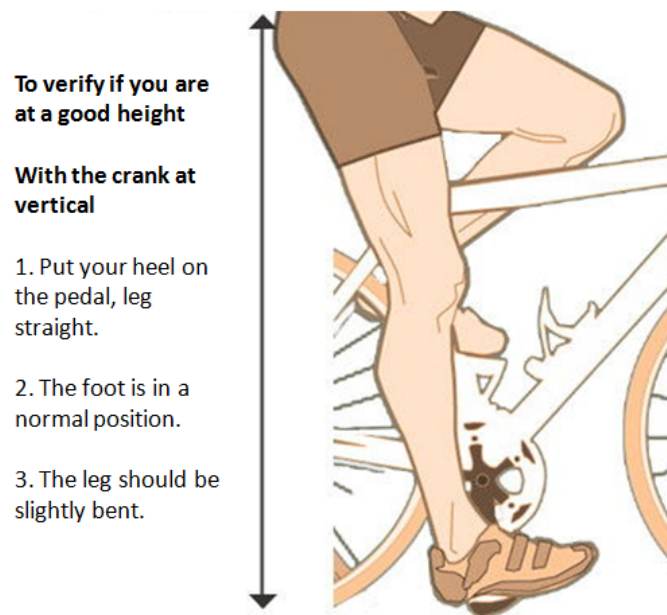

Figure 1 : Adjustment of the height of the saddle (source velotech.fr)

On this urban bike with which you will have to stop frequently, and have maximum stability when stopped, we recommend that you keep your leg slightly bent so that you can put your feet on the ground more easily.

The height adjustment is carried out by opening the quick saddle lock. After adjusting the height, close the quick release lever. If necessary, adjust the tightening of the lock nut so that the lever stroke hardens about halfway.



Figure 2 : Locking the seat post

In the case of a screw clamp, tighten to 5/8 Nm.

**WARNING**

NEVER EXCEED THE SADDLE HEIGHT LIMIT SHOWN BY THE INSCRIPTION 'INSERT MINI' OR 'STOP'. YOUR SAFETY, AS WELL AS THE RELIABILITY OF YOUR BIKE IS PUT AT RISK. IF YOU CANNOT GET THE RIGHT SADDLE ADJUSTMENT WITHOUT EXCEEDING THIS LIMIT, CONTACT YOUR DEALER.



Figure 3 : Respect the minimum sinking of the seat tube



Figure 4 : Minimum sinking mark on the seat tube

### 3.2. Seat tilt

We have fitted our bikes with ergonomic saddles, but careful adjustment is necessary to optimize comfort.

It is generally advisable to adjust the saddle horizontally.

The saddle recoil will be adjusted according to the length of the femur. This is a more complex setting which may require the assistance of your retailer (see drawing). In general, an intermediate recoil is suitable.

The carriage fixing screw must be tightened to around 15 Nm so that the saddle can no longer move. If you cannot find your location, ask your retailer for advice.



Figure 5 : Adjusting the saddle carriage

### 3.3. Handlebar adjustment

The inclination of the stem is adjustable, make sure to respect the tightening torques indicated on the part.

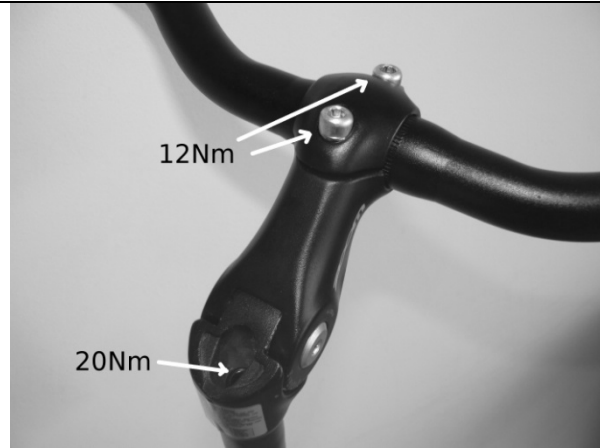

Figure 6 : Torque settings for the handlebars and the stem



Figure 7 : Inclination of the stem, tightening torque

## 4. Settings

### 4.1. Enviolo continuously variable gearing

This shift system is available on some models and provides unmatched comfort and ease of use. It allows stepless gear shifting, even under load. However the gear change will be more flexible if you ease pedalling pressure.

Once set up, the NuVinci hub requires no special maintenance, but below are some basic usage and maintenance tips.

#### 4.1.a Checking the cable tension

- 1 - The cable tension can be adjusted using the tensioners (item 1 in Figure 11) located on the handle.
- 2 - The cable tension can be determined by pulling slightly on the sheath and noting a slight slack: between 0.5 and 1.5 mm, this is the ideal play. For easier removal of the rear wheel, it may be necessary to loosen the cables a little and thus facilitate the removal of the cable ties from the hub

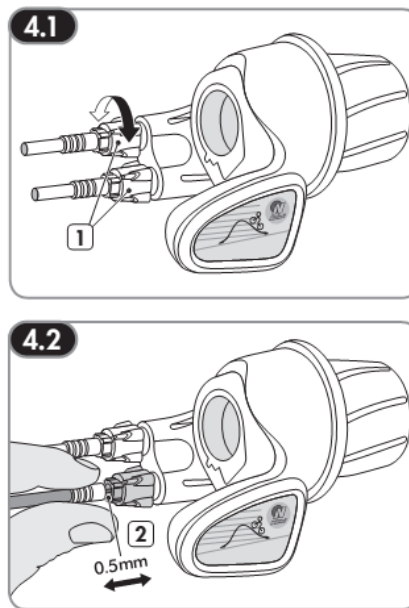

Figure 8 : Adjusting the clearance of the Enviolo control cables

#### 4.1.b Removing the rear wheel

Position the hub in a position that makes it easier to access the cable clamps.

3 - Remove the cable ties following steps A, B and C of Figure 9.

4 - Loosen and / or remove the wheel nuts (3) and the anti-rotation washers (4) according to Figure 10 - You can now remove the rear wheel.

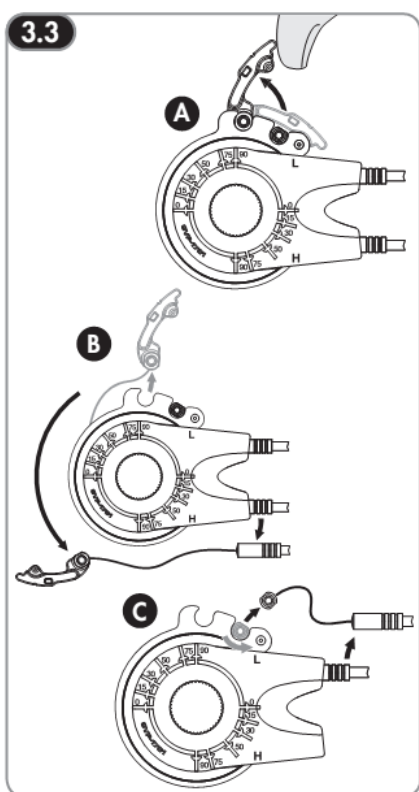

Figure 9 : How to remove the control cables for disassembly of the wheel

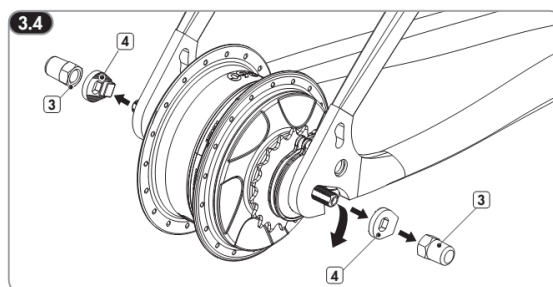

Figure 10 : Remove the anti-rotation washers and nuts

#### 4.1.c Refitting the rear wheel

Place the rear wheel in the frame at the bottom of the groove, being sure that nothing obstructs the cable clamps.

- 5 - Place the anti-rotation washers as shown in Figure 14, then the nuts, and finally tighten to a torque of 30 Nm.
- 6 - Install the cables and sheaths by following steps A, B and C in Figure 15. Check that the spring is correctly clipped.

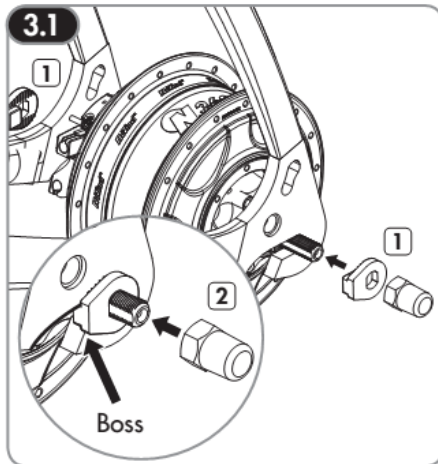

Figure 11 : Replace the anti-rotation washers and nuts

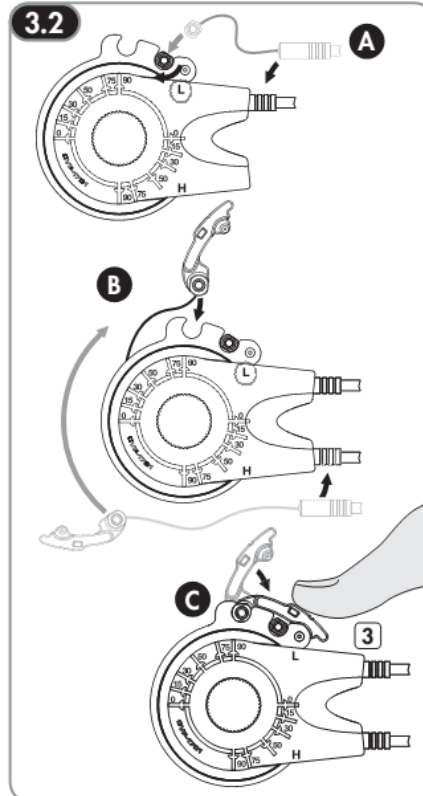

Figure 12 : Replace the control cables to install the wheel

**WARNING**  
 IMPROPER INSTALLATION OF ANTI-ROTATION WASHERS MAY DAMAGE THE FRAME AND THE HUB.  
 OVER-TIGHTENING MAY DAMAGE PARTS. UNLOCKING MAY CAUSE THE HUB TO SLIDE IN THE FRAME.  
 DO NOT PRESS THE SPRING BLADE WHEN PLACING IT.

#### 4.1.d Cleaning

The Enviolo and Shimano hub are waterproof and well protected from the outside environment. However, it is strongly recommended not to use high-pressure washing to clean your bike, in order to avoid water infiltration which can cause a malfunction of the hub. During the winter season, you should clean your bicycle at more regular intervals to avoid any problems that may be caused by salt on the roads. Do not use harsh products. Hot water and dishwashing detergent are the most simple and effective.

#### 4.1.e Lubrication

The Enviolo continuously variable rear hub control lever operates very intuitively. As you can see in the two photos below, the small pictogram on the photo shows the profile of the terrain.

#### 4.1. Operation of the shifter

The Enviolo continuously variable rear hub control lever operates very intuitively.

As you can see in the two photos below, the small pictogram on the photo shows the profile of the terrain.



Figure 13 : In this position ('full overdrive'), the gear ratio is large. As the pictogram shows, this position is used when the ground is flat or downhill.



Figure 14 : In this position the gear ratio is small. This position is used whilst the terrain is uphill, when it becomes difficult to pedal while maintaining a consistent cycling cadence

#### NOTE

When stopped, the handle does not fully rotate. Do not force the handle unnecessarily or apply excessive pressure. As soon as the wheel turns, the movement is complete.

## 4.2. Brakes

#### WARNING

IN RAINY TIMES THE BRAKING DISTANCES ARE LONGER.

WITH LITTLE REAR LOADING PLEASE REDUCE YOUR BRAKING EFFORT IN ORDER TO AVOID LOCKING THE REAR WHEEL.

For optimum braking performance, Bike 43 bikes use hydraulic disc brakes.

Bike 43 bikes are assembled as follows:

- Front brake: left lever
- Rear brake: right lever

On a hydraulic disc brake, the wear of the pads is compensated automatically. Simply check the alignment of the pads with the disc, having previously checked that the wheel is in the bottom of the dropouts. Correct alignment guarantees the absence of noise and regular wear of the pads.

The adjustment is made by loosening the brake caliper fastening screws and moving its position guided by the holes in the brake disc. You can easily align the caliper by holding the brake lever down and gradually tightening the fixing screws (to 10 Nm). After releasing the lever, the caliper should be aligned with the disc.

#### WARNING

THIS IS A DELICATE OPERATION ON A SECURITY ELEMENT. IF YOU DO NOT HAVE THE NECESSARY SKILLS, DO NOT ATTEMPT THIS SETTING AND APPOINTMENT AT YOUR AUTHORIZED DEALER.

## 4.3. The wheels

### 4.3.a The tyres

We have equipped your Bike 43 bike with high-performance tyres from the best brands. It is advisable to take into account their particular characteristics, in order to be able to enjoy them as long as possible.

The maintenance of a tyre requires:

- Healthy rims and the rim tape in good condition.
- The application of a little talcum powder from time to time on the inner tube and inside of the tyre.
- Correct pressure. For this, refer to the ranges of use written on the sidewall of the tyre. You do not need to inflate the tyre to the maximum value indicated, but rather according to the level of comfort / performance you want.
- As an indication, we recommend between 3.5 bars (comfort) and 4.5 bars (range) for Schwalbe Big Apple tyres, and 5 bars for Schwalbe Road Cruiser tyres.

Frequently check and remove any foreign objects that may enter the studs or the surface of the tyre. Certain models of tyres have specific tread patterns requiring a forced direction of rotation. Respect this direction, as indicated by the arrow on the side of the tyre.

## 4.4. The stand

The stand is made of high strength steel. It is positioned as close as possible to the rear wheel for more stability when loading the luggage carrier. It is designed to keep the bike upright, the weight being taken up by the rear wheel.

**WARNING**  
THE STAND IS NOT SIZED OR GUARANTEED TO RESIST THE WEIGHT OF AN ADULT SITTING ON THE SADDLE. IT IS PROVIDED TO SUPPORT ONLY THE REAR LOAD ON THE PROVISION THAT THE REAR WHEEL IS TOUCHING THE GROUND

## 5. Miscellaneous recommendations

### 5.1. Tightening torques

Handlebar stem	See component
Brake calipers	8 Nm
Brake discs	4 Nm
Front wheel nuts with motor	45 Nm
Front wheel nuts with dynamo	20 Nm
Rear wheel nuts	40 Nm
Brake cables	6-8 Nm
Brake levers	6-8 Nm
Derailleur shifters	5 Nm
Seat clamp	6-8 Nm
Saddle	15 Nm

For all other fasteners, respect the following values:

M4	2.5 Nm
M5	6 Nm
M6	10 Nm
M8	25 Nm
M10	50 Nm

## 6. Maintenance

### 6.1. Battery

The battery is an essential part of your Bike 43 bike.

By following a few simple rules, you can optimize its lifespan.

- Do not store your discharged battery, it could go into deep discharge which will reduce its lifespan.
- Get in the habit of charging it when you get back, so your bike is always ready to go.
- It's not bad to charge it frequently.
- The battery can be stored for up to 1 year without charging it, but it must be previously charged to 50/60%. The minimum charge level of 50% must be respected to keep the guarantee valid.
- Even if it supports storage temperatures from -20 ° C to + 60 ° C, you optimize its lifespan by storing it at room temperature (20 ° C).
- Respect the conditions of use between -5 ° C and 40 ° C.
- Do not leave your battery exposed to high temperatures or direct sunlight for a long period of time (for example on the rear shelf of a car in direct sunlight).
- Keep the contacts always clean and do not insert metallic objects into them.
- Batteries are specifically designed for recycling.
- Do not put them in a recycling center. The treatment is specific.
- Please note the transport of Lithium-ion batteries is subject to certain rules.

## 6.2. Maintenance schedule

In order to extend the life expectancy of your bike, here is an example of a maintenance schedule, in the case of regular use.

### 6.2.a Before & after each trip

- Check the brakes.
- Check the tyre pressure and any damage.
- Check the lighting.
- Check the wheel tightness.
- Check the tightness of the stem and handlebars.
- Make sure the battery is securely locked to the frame.
- Store your bike carefully in a clean, dry place.
- Recharge your battery.

### 6.2.b Every months

- Inspect for any play in the stem and hanger.
- Check the cassette as well as the chain
- Check the cables, hoses, levers.
- Check the wear of the pads, brake pads, replace them if necessary.
- Check the wheel run out, and the spoke tension.

### 6.2.c Every six months (depending on the frequency, and the type of use)

- Inspect the frame and look for the appearance of possible cracks.
- Check the play in the bottom bracket and the attachment of the cranks to the bottom bracket.
- Check and grease the wheel hubs, headset, brake levers and all friction parts.
- Check the fixing of the pedals in the cranks.

For a more effective inspection, it is advisable to go to your authorized dealer, in order to carry out an in-depth inspection.

### 6.2.d Every two years

Replace the handlebar and the stem

### 6.2.e Safety warning

**CAUTION** Like any mechanical component, a bicycle undergoes high stresses and wears out. Different materials and components can react differently to wear or fatigue. If the expected service life of a component has been exceeded, it can rupture suddenly, risking injury to the cyclist. Cracks, scratches and discolouration in high stress areas indicate that the component has exceeded its service life and should be replaced.

## 7. Cleaning and lubrication

After your ride, you can wash your bike in soapy water (dishwashing liquid is recommended for its high degreasing power, without being corrosive). But do not use a pressure washer, if possible. If you cannot do otherwise, never direct the jet directly at the bearings and seals, nor at the motor and the battery.

We recommend that you remove the battery and the bike computer / HMI before cleaning, and wash them separately with a damp cloth. Dry with a soft cloth to remove water droplets and moisture residue to avoid the risk of corrosion. This operation allows you at the same time to make a visual check of the tubes of your bike (useful for perceiving possible incipient cracks).

Before storing it properly, lubricate the transmission components with a product specially designed for this purpose. Take advantage of this to check the wear and tear of the brakes, the brake lining, and any play.

**WARNING**  
NEVER SPRAY OIL ON THE CHAIN WITHOUT PRIOR PROTECTION OF THE BRAKE DISCS.  
WITHOUT THIS, FINE DROPLETS CAN POLLUTE THE DISC AND THE PADS AND REDUCE THE BRAKING PERFORMANCE. POLLUTED PADS MUST INEVITABLY BE REPLACED.

## 8. Parts subject to wear

Regularly check the parts that are subject to wear, in particular the braking and transmission elements so as not to take any risks. If you are in doubt as to the wear of certain components, please refer to the component's instructions or to your retailer. Prevention is better than cure, so never wait until the last moment!

The chain of your cargo bike is stressed. Check its wear regularly and replace it regularly. Ask your retailer for advice if in doubt.

Take the time regularly to check that no link is deformed or open as it could break while rolling and cause you to fall.

List of different parts subject to wear:

- Braking elements (pads, rims, pads).
- Tyres, inner tubes, rim tape.
- Cables and sheaths.
- Transmission elements (chain, chain ring, sprocket, bottom bracket, chain tensioner rollers)..

## 9. Basic information on the pedal assistance system

### 9.1. Getting started

- Remove the feet from the pedals (to allow the initialisation of the force sensor)

### 9.2. Lithium-ion battery

The battery should be charged fully before the first use. Charging can be done either on the bicycle or off the bicycle with the battery removed.

To charge the battery, proceed as follows:

- Remove the dust cap from the charging socket on the battery housing
- Plug the charger into a mains socket outlet
- Connect the charging plug to the socket

#### CAUTION

TO GUARANTEE CORRECT POLARITY WHEN CHARGING, THE CHARGING SOCKET HAS A KEYWAY. NEVER TRY TO INSERT THE CHARGING PLUG IN A DIFFERENT POSITION WITH FORCE!

The charging time is about 6h30.

- Unlike other types of battery, the lithium-ion battery has no 'memory effect' of any kind. This means that it does not need to be fully discharged before it can be charged up again. **It actually helps to prolong the battery's life if the charging cycles are flat, in other words if the battery is always charged up again immediately after use.**
- **During the charging process, the ambient temperature should not lie below 10°C or above +35°C.**
- Charging outside this temperature range reduces the available battery capacity and therefore the range. It is advisable to charge the battery in a heated room when outdoor temperatures are below zero. Direct sunlight and proximity to sources of heating such as radiators must be avoided.
- Before long periods of inactivity, e.g. in winter, the battery should be fully charged up and stored in a
- dry, frost-free place. Charge the battery completely before using again.
- The battery delivers maximum performance **at room temperature**. When starting a journey, the temperature of the battery should therefore not lie below 10°C or higher than +25°C.
- The battery can become quite hot on long journeys using a lot of motor power. Temperature monitoring inside the housing prevents charging in excessively high temperatures. The charger can be connected in this case. Charging will start automatically when the battery has cooled down sufficiently. The battery can easily take up to an hour to cool down following a long uphill ride.

The following ambient temperature ranges must be maintained to ensure that the battery works correctly:

Operating mode	Temperature range
Normal operation	-10 to +45°C

Charging	+10 to +35°C
Storage	-10 to +45°C

## 10. Guarantees and after-sales

### WARNING

IN CASE OF PROBLEMS, TAKE YOUR BIKE WITH THE PURCHASE INVOICE TO YOUR BIKE 43 DEALER. HE WILL MAKE A FIRST DIAGNOSIS OF THE PROBLEM. HE ONLY HAS THE AUTHORITY TO RETURN THE BIKE AND TO MAKE A REQUEST FOR WARRANTY FOR A RELATED PART. IT IS FOR BIKE 43 TO DECIDE ON THE VALIDITY OF ANY CLAIM UNDER THE GUARANTEE.

This warranty takes effect from the date of purchase. It is only granted for normal bicycle use.

In case of professional use, please contact us.

Your Bike 43 is guaranteed against manufacturing defects for a period of 2 years from the date of purchase, with the following reservations.

### 10.1. Warranty only applies

- On bicycles purchased from one of our authorized BIKE 43 dealers,
- to the first owner of the bicycle (the guarantee does not transfer to the following buyers in the event of resale),
- in the event of normal use of the bicycle.
- The warranty is limited to the repair or replacement of the defective part (s).

The warranty is for a period of 1 year:

- On the stickers and paintwork

We offer a life time warranty on frames for Bike 43s purchased in the official network of dealers. It is provided to original owners only (not transferable) for normal usage of the bicycle (professional usage is not covered by this warranty).

Enviolo and Shimano parts are guaranteed by the manufacturer.

## **10.2. The warranty does not apply**

- If the complaints are consecutive to the use of the bicycle in competition, for professional use or outside the conditions of use detailed in the section 'Type of use'
- if it is found that the defect is due insufficient maintenance or negligence on the part of the buyer,
- in the event of accidents or other abnormal or excessive conditions of use,
- in the event of a major modification carried out on the bicycle without prior written authorization from bike 43,
- in the event of the impact of elements or external circumstances (natural disaster, fire, humidity),
- if used in a manner that does not comply with technical and safety standards.
- The warranty does not cover labour related to the replacement of parts under warranty.
- With normal bicycle wear.

The warranty does not apply to the wearing parts listed in the Maintenance paragraph.

The conditions of this warranty can only apply if the bicycle is purchased in the territory of the United Kingdom or European Union and remains there.

No seller or distributor may modify the terms of this warranty, unless the seller or distributor replaces bike 43's warranty conditions with his own warranty conditions at the top of his company.



Bike43 SRL, Avenue des Paturins 1, 1180 Uccle

BE 0784.757.714

<https://www.bike43.com>

This manual complies with safety requirements.

Veillez noter les informations ci-dessous et les conserver précieusement. Elles vous serviront en temps utile.

Frame serial number: \_\_\_\_\_

Frame padlock key number: \_\_\_\_\_

Battery key number: \_\_\_\_\_

Date of purchase : \_\_\_\_\_

Distributor stamp:

--